



FITTING INSTRUCTIONS

Part #: 0000-8W-L46

2014 MAZDA3 4-Door & 5-Door

Paint Protection Film: Door Edge & Cups

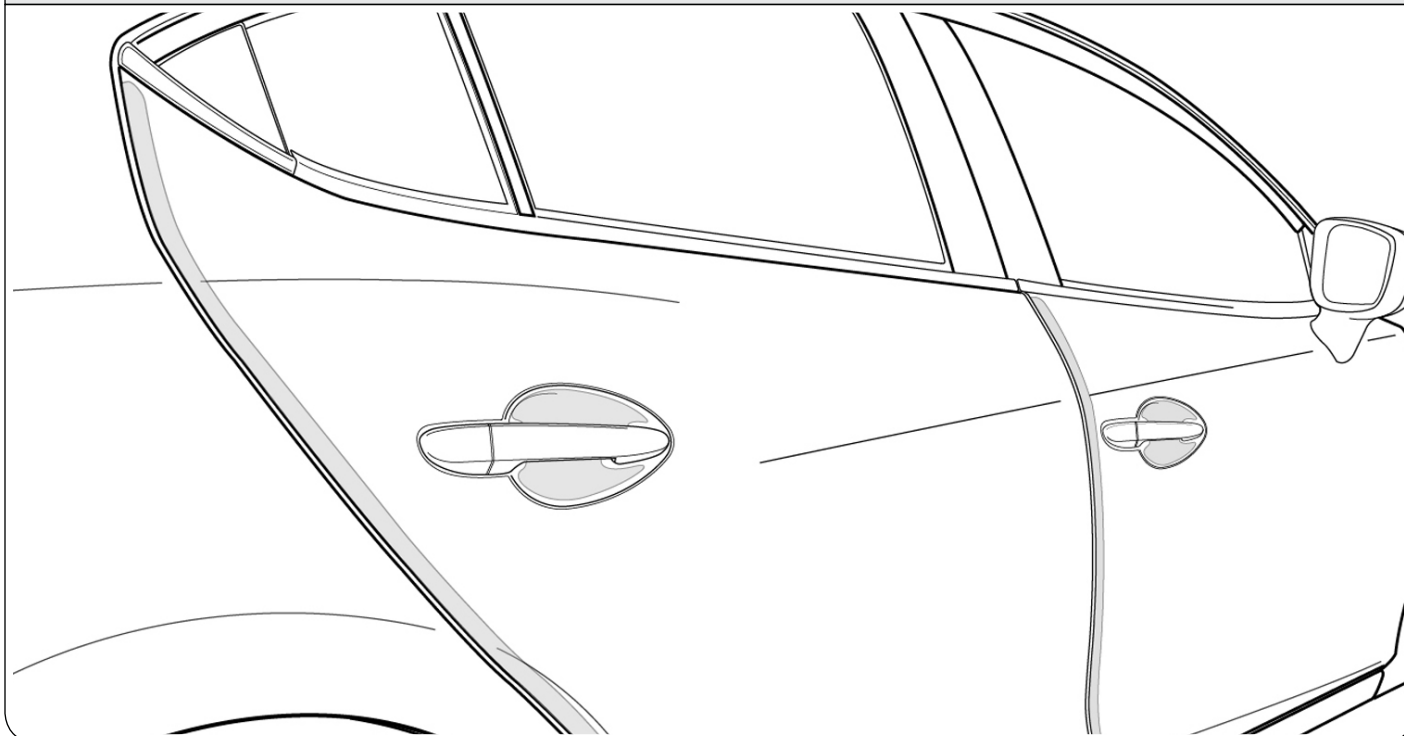

Kit Contents

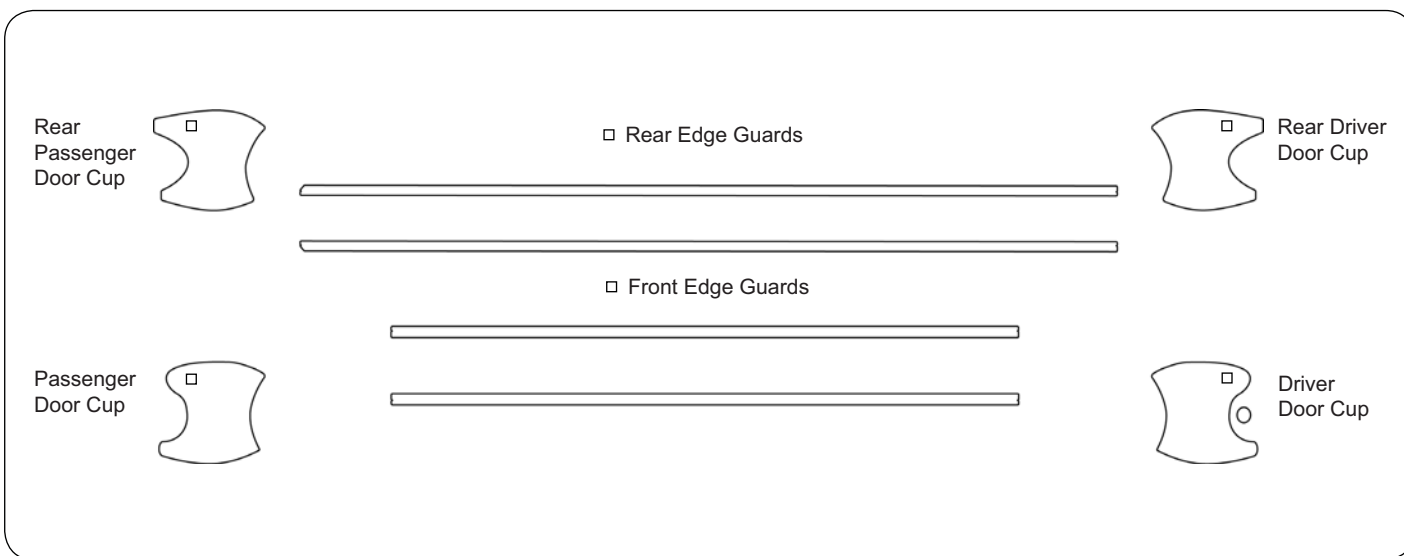

Tools

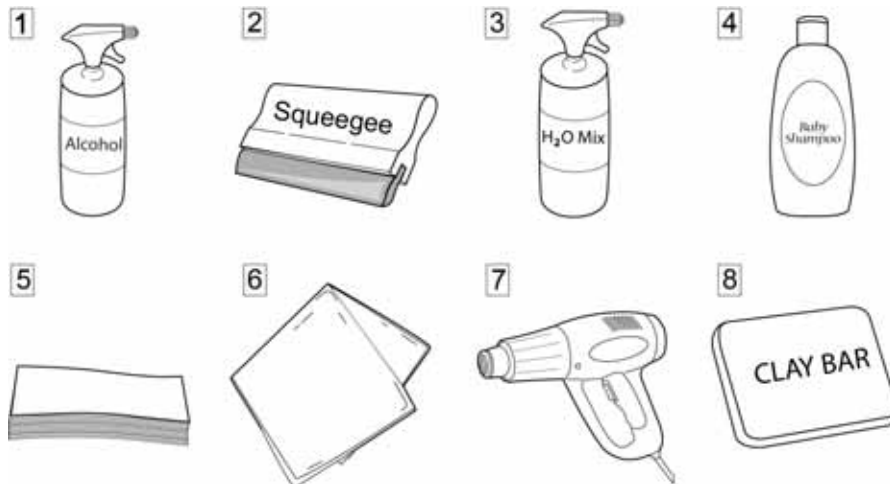

1. 70% Isopropyl Alcohol
2. Squeegee
3. H₂O Mix
4. Baby Shampoo
5. Wipes
6. Microfiber Towels

Optional Tools:

7. Heat Gun
8. Clay Bar
9. Supplementary Tools

Installation Solution Mixture Guide

Baby Shampoo & Water Solution

The solution mixture is extremely crucial for a proper installation. The mixture will vary depending on temperature. Follow the instructions and see the chart for guidance.

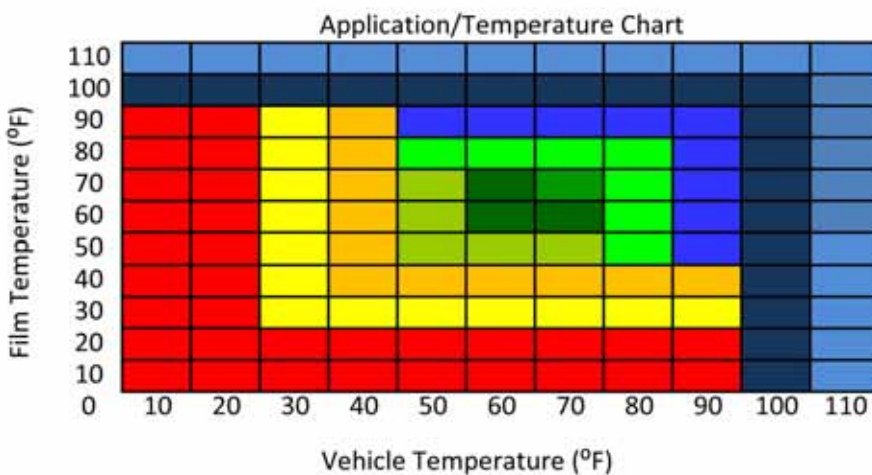

What you'll need:

1. (2) 32 oz Spray Bottles
2. Water (Distilled Preferred)
3. 70% Isopropyl Alcohol

Mixing Installation Solutions:

1. Fill up 1st spray bottle with water (distilled preferred).
2. Add 4 drops of Unscented Johnson's Baby Shampoo
3. Shake Well
4. 2nd spray bottle will be used for Isopropyl Alcohol. This accelerates the adhesive to be more aggressive. It will be 60% water and 40% alcohol. It is used for tacking areas and holding edges from lifting.

- Install Not Recommended at temp. Cool down car or film by spraying cold water on vehicle surface.
- Install Not Recommended at temp. Cool down car or film by spraying cold water on vehicle surface.
- Good Install Conditions. Mix 6 drops of shampoo to 32 oz of water (distilled preferred), compensate for heat.
- Excellent Install Conditions. Mix 5 drops of shampoo to 32 oz of water (distilled preferred).
- Ideal Install Conditions. Mix 4 drops of shampoo (aprox 1/4 in size) to 32oz of water (distilled preferred).
- Excellent Install Conditions. Mix 4 drops of shampoo (aprox 1/4 in size) to 32oz of water (distilled preferred).
- Good Install Conditions. Decrease amount of soap, add 2-4 oz of 70% isopropyl alcohol to mix.
- Install Not Recommended at this temperature. Warm up vehicle's paint and film before applying.
- Install Not Recommended at this temp. Warm up vehicle's paint and film before applying.
- Install Not Recommended at this temp. Warm up vehicle's paint and film before applying.

Vehicle Cleaning Prep

- 1 Always before applying PPF film be sure to clean and prep the surface using an alcohol based cleaner or degreaser if needed. Additional prep may include using a clay bar to clean very small stubborn debris.

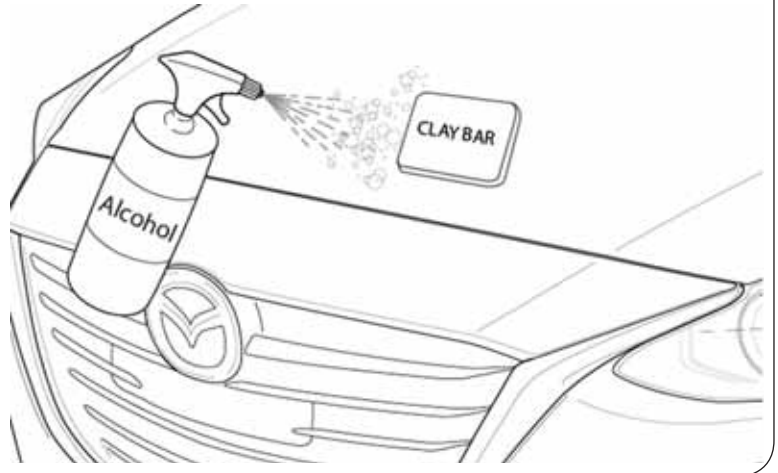

Door Cup Application: Driver Door Cup

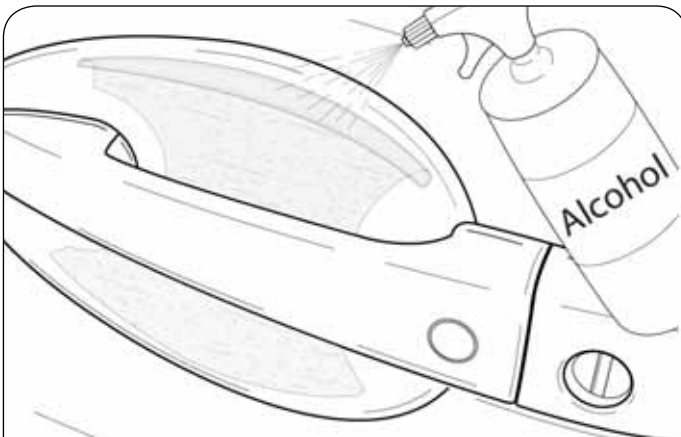

- 1 Prep surface for film placement. Alcohol entire area and place film into door cup.

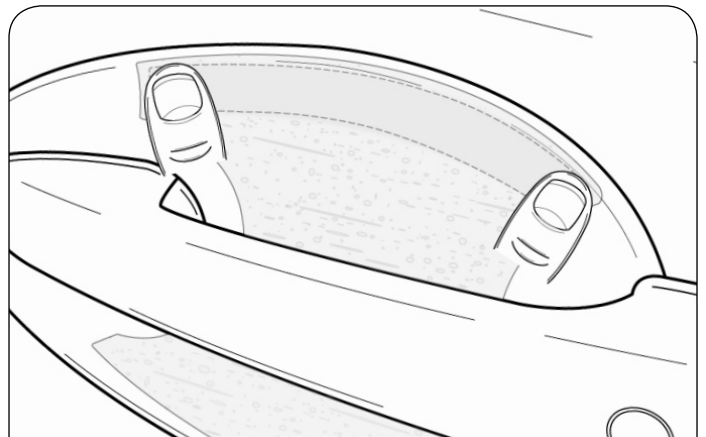

- 2 Create temporary alcohol tacks using your thumbs on the top regions pictured.

Door Cup Continued →

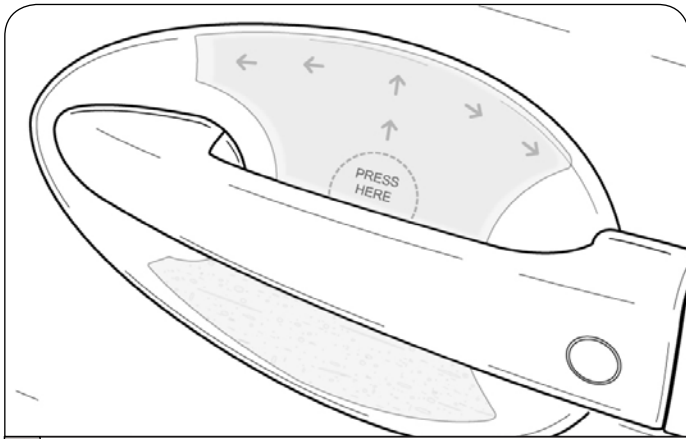

3

Using your thumb press down in center of the door cup, move upwards and out, fastening the sides of the film down.

Squeegee down area after finished.

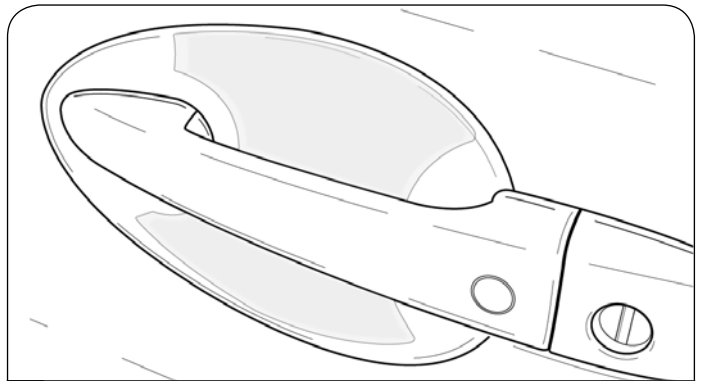

4

Bottom Half:

Repeat the process in step 3 for the bottom half of the door cup. Except move thumb downwards and out fastening the sides of the door cup down. Then use squeegee on door cup.

Driver door cup completed!

Note: Remaining Door Cups

REPEAT ALL STEPS (1-3) FOR:

- Passenger Door
- Rear Passenger Door
- Rear Driver Door

Door Edge Application

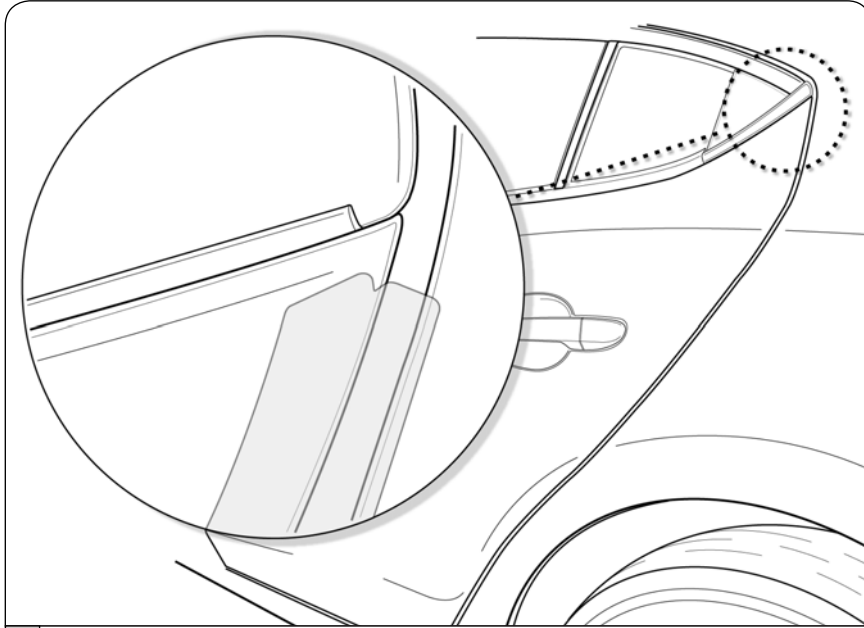

- 1 Door edges will be installed dry, (**NO ALCOHOL**) match the “V” cut in film to the edge of the door as shown in picture. It should be somewhere in the middle, enough to wrap around the door. Once aligned apply pressure to film.

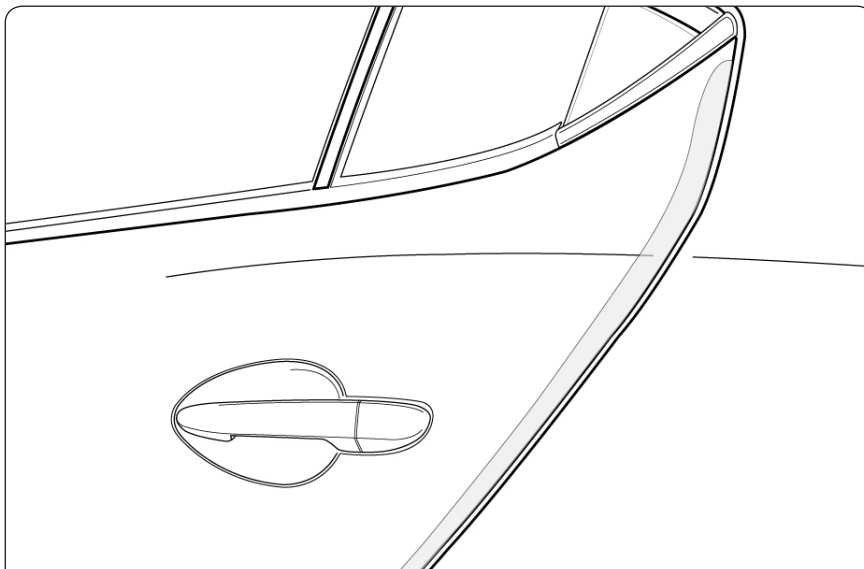

- 3 Once film is aligned to door edge surface open door and half of the film strip should hang over. Using your finger gently stroke hanging film inward, slowly and cautiously until entire edge is positioned in place.

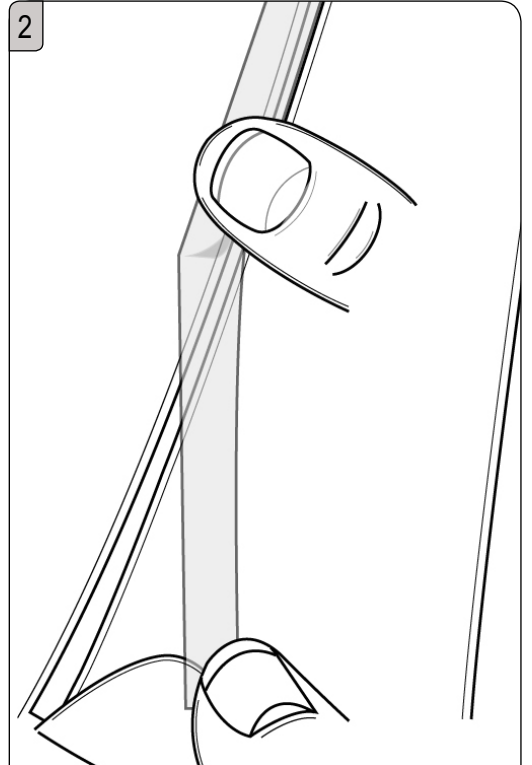

2 With door closed use the inside edge of film with the other door's edge to help align and place the strip onto the outside of the door edge.

Using your thumb lightly apply pressure and use other hand to pull excess film.

Guide strip down the length of the door edge following the shape and contour of the door.

Note:

REPEAT ALL STEPS (1-3):

for application of edge guards on all remaining doors.

Finishing Steps

After all parts of kit are installed (edge guards and door cups). Dry kit pieces using a heatgun.

ALL STEPS COMPLETED!

